

Ansicht A

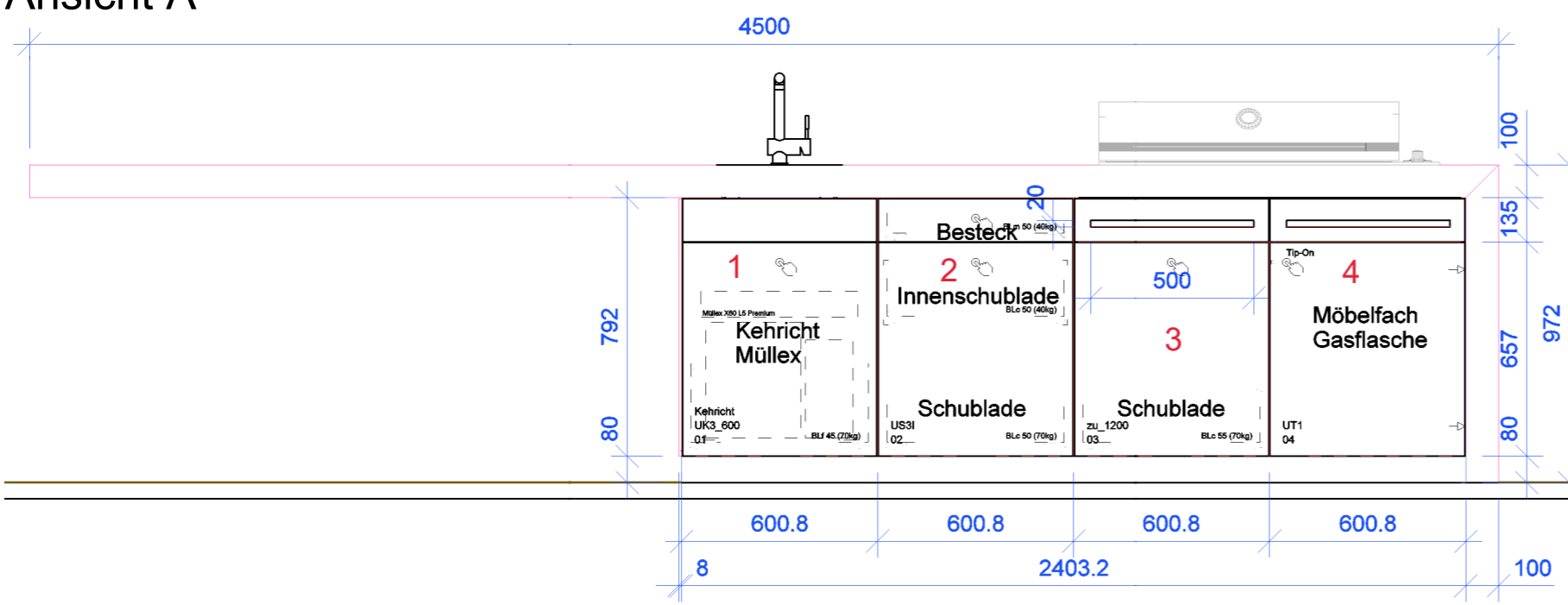

Ansicht B

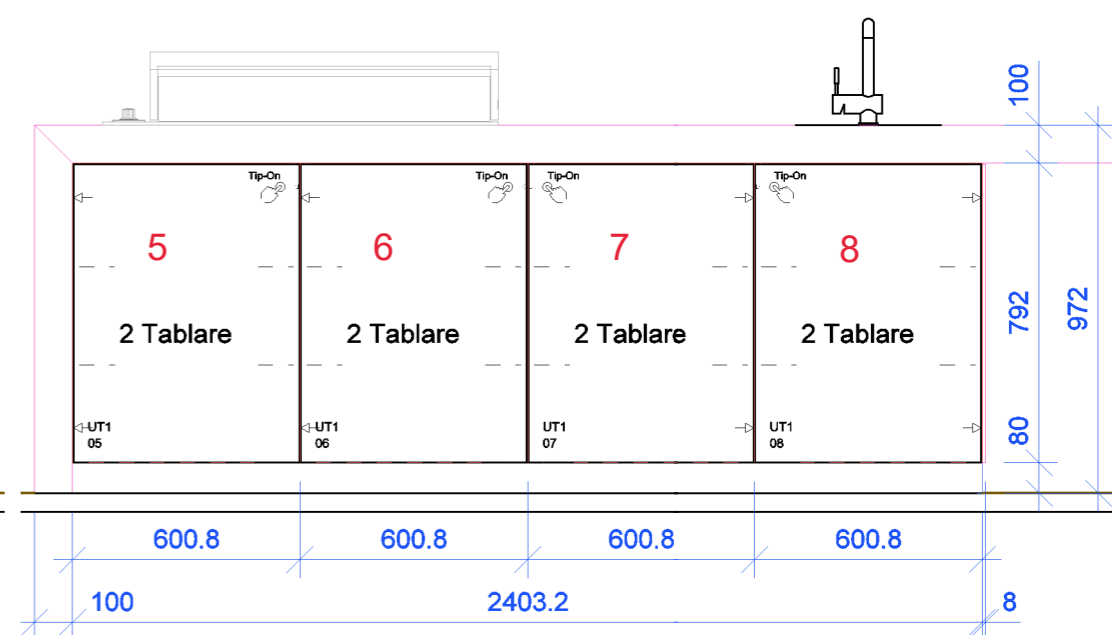

Sockel

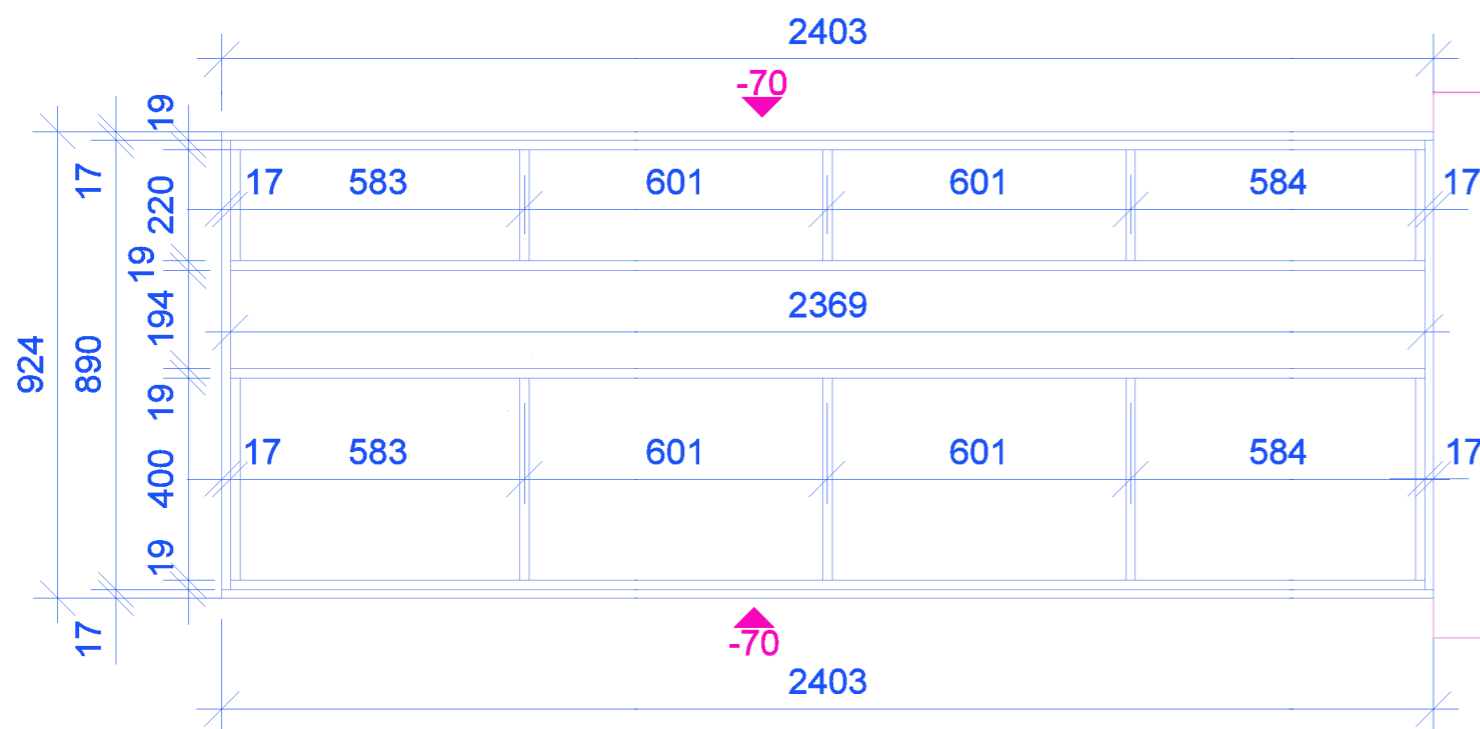

SR Pos.03+06

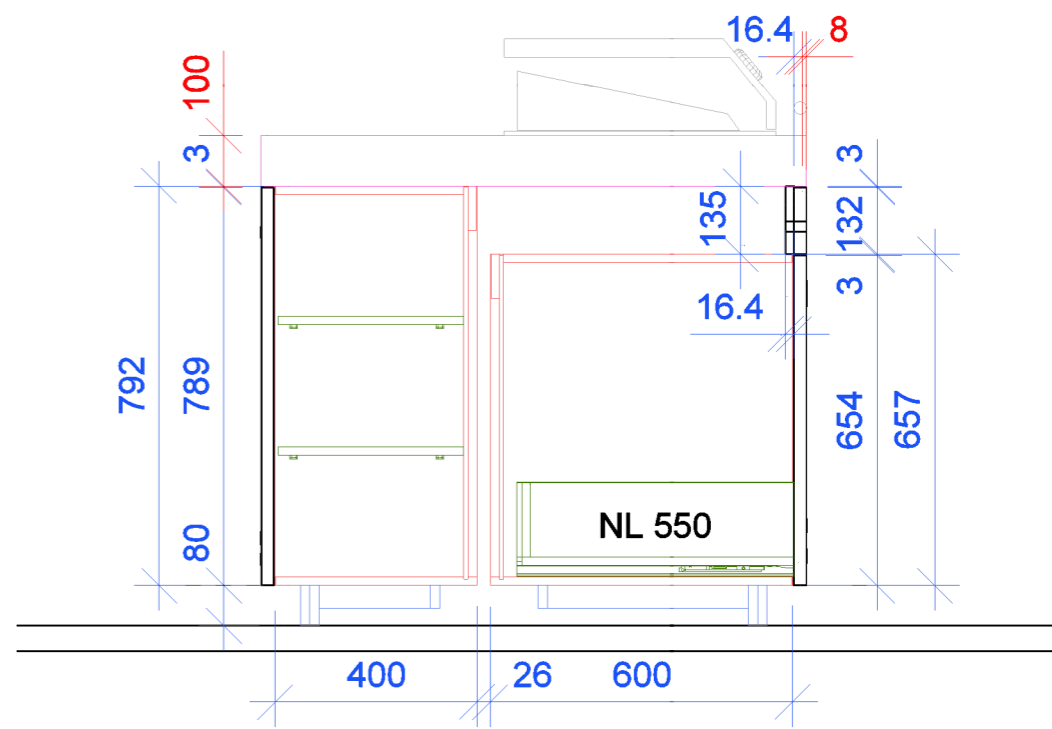

Möbel

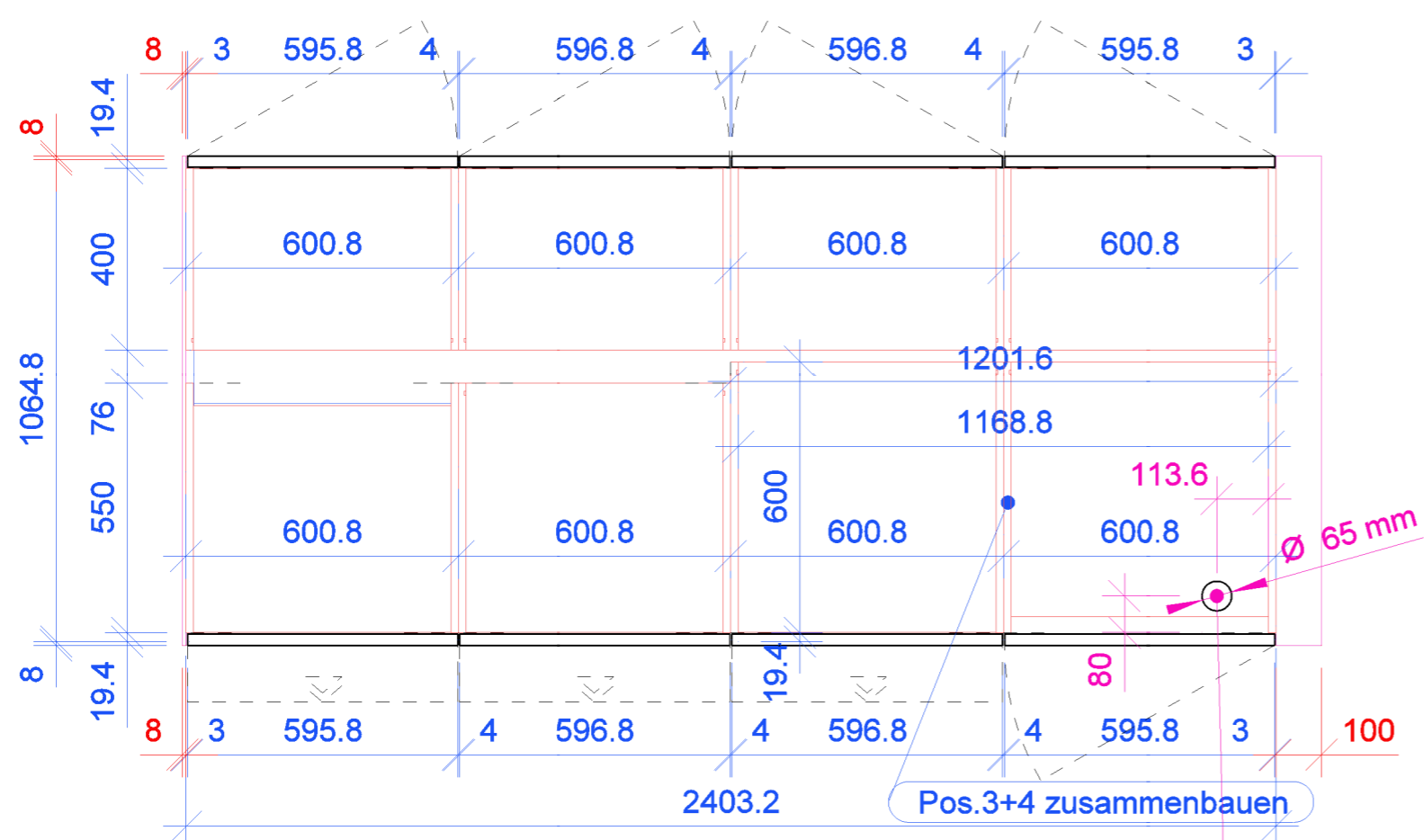

Beplankung Keramik bauseits

Bohrung Ø 65 mm für Gasschlauch in Zw-Bo Pos.4

SR Pos.04+05

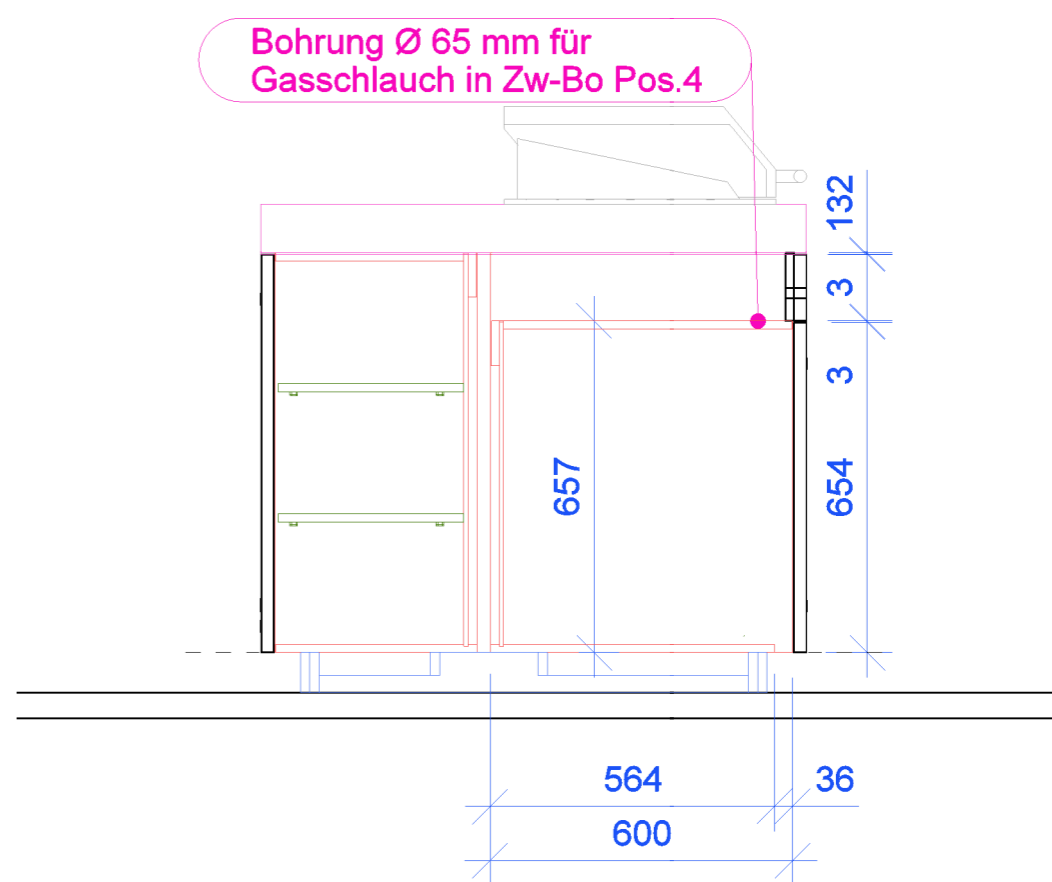

Blindfront und 1/6 Front Pos.3+4

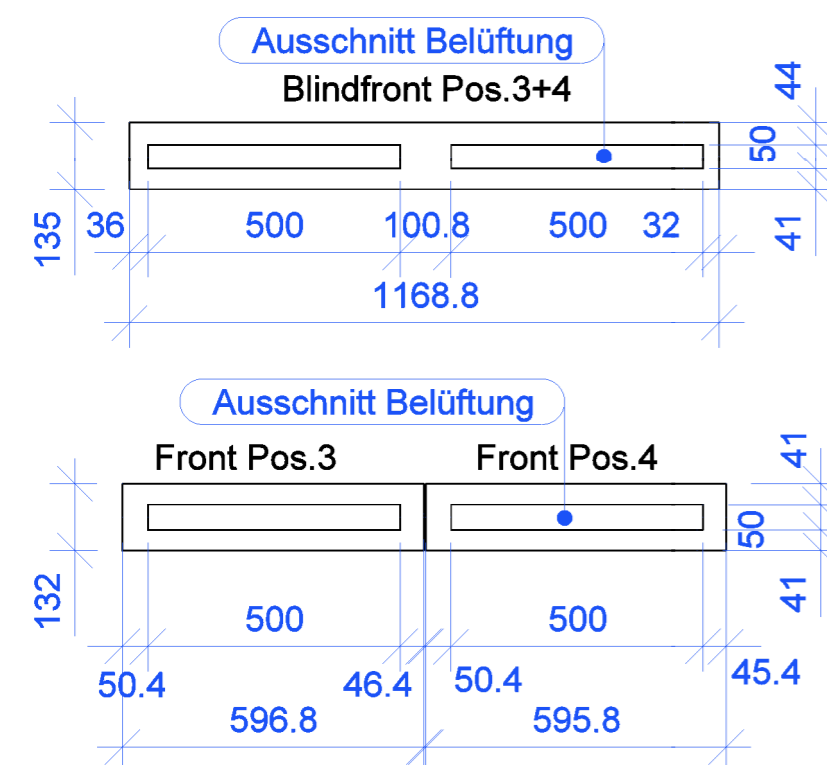

Frontschnitt Pos.04+05

